



# Introfashion / Bobo

## Lighting Proposal

# Introfashion - Bobo

Lux Report

## Room 1

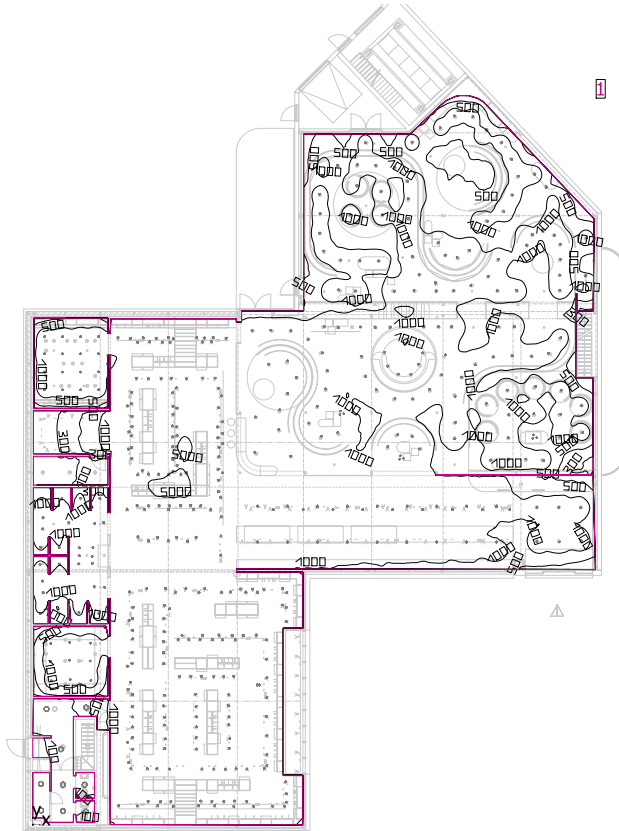

Clearance height: 3.200 m, Reflection factors: Ceiling 75.5%, Walls 46.0%, Floor 90.0%, Maintenance factor: 0.80

### Workplane

| Surface       | Result   | Average (Target) | Min  | Max  | Min/average | Min/max |
|---------------|--|------------------|------|------|-------------|---------|
| 1 Workplane 1 | Perpendicular illuminance (adaptive) [lx]<br>Height: 0.800 m, Wall zone: 0.000 m | 1713 (≥ 500)     | 29.4 | 5649 | 0.02        | 0.01    |

| #                        | Luminaire   | Φ(Luminaire) [lm] | Power [W] | Luminous efficacy [lm/W] |
|--------------------------|---|-------------------|-----------|--------------------------|
| 6                        | AURORA - LED Eddi Reflector 1000lm 3000K Wide beam Pg6        | 962               | 10.0      | 96.2                     |
| 161                      | AURORA - LED Eddi Reflector 2000lm Medium beam                | 1942              | 19.0      | 102.2                    |
| 22                       | AURORA - LED Eddi Reflector 2000lm Wide beam                  | 1954              | 19.0      | 102.8                    |
| 247                      | AURORA - LED Eddi Reflector 3000lm Medium beam                | 2958              | 31.0      | 95.4                     |
| 7                        | ENLITE - 15W Polycarbonate IP66 Round LED Bulkhead EN-BH15/40 | 1152              | 15.0      | 76.8                     |
| 9                        | ENLITE - 220-240V GLS E27 7W GLASS LED LAMP EN-GLSE277/27     | 256               | 7.0       | 36.6                     |
| 2                        | ENLITE - LED EMERGENCY BULKHEAD EN-BH15WEMMS                  | 1162              | 19.2      | 60.5                     |
| Total via all luminaires |   | 1104740           | 11400.4   | 96.9                     |

Lighting power density: 11.55 W/m<sup>2</sup> = 0.67 W/m<sup>2</sup>/100 lx (Floor area of room 986.80 m<sup>2</sup>)

The energy consumption quantities refer to the lights planned for the room without taking into account light scenes and their dimming levels.  
Consumption: 31350 kWh/a of maximum 34550 kWh/a



## Workplane 1 / Perpendicular illuminance (adaptive)

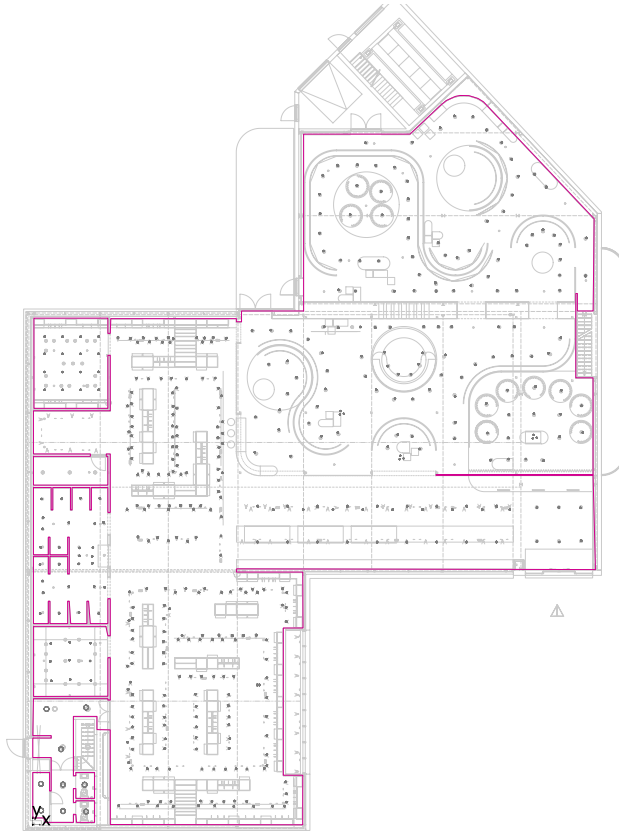

Workplane 1: Perpendicular illuminance (adaptive) (Surface)

Light scene: Light scene 1

Average: 1713 lx (Target:  $\geq 500$  lx), Min: 29.4 lx, Max: 5649 lx, Min/average: 0.02, Min/max: 0.01

Height: 0.800 m, Wall zone: 0.000 m

Isolines [lx]

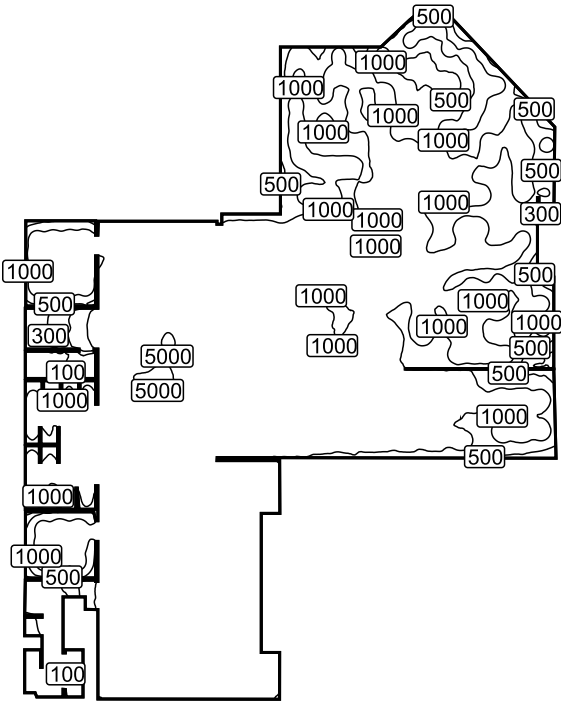

Scale: 1 : 500

False colours [lx]

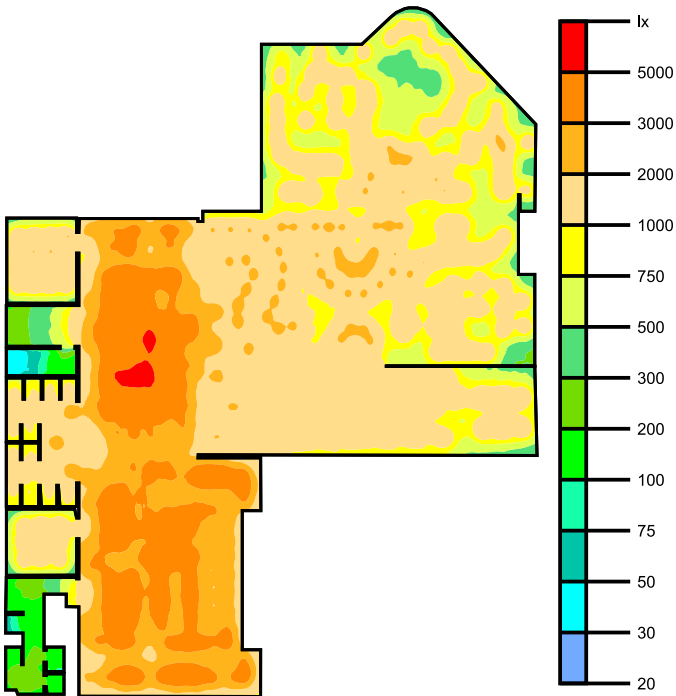

Scale: 1 : 500

Value grid [lx]

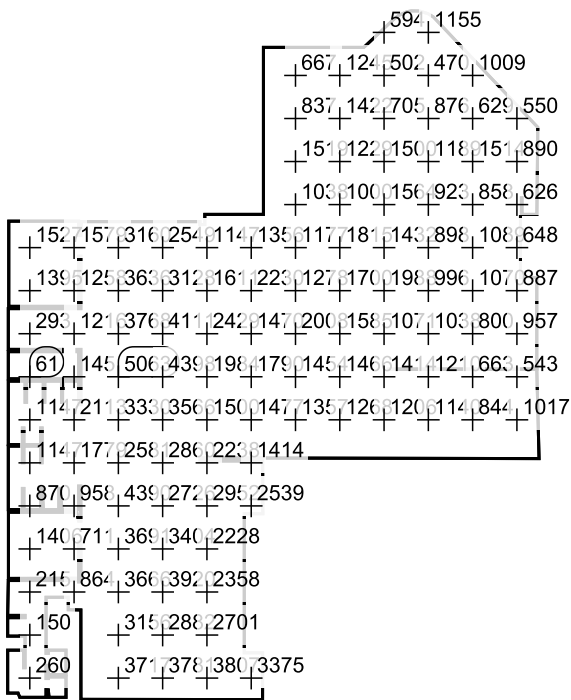

Scale: 1 : 500

Bobo Gedeelte

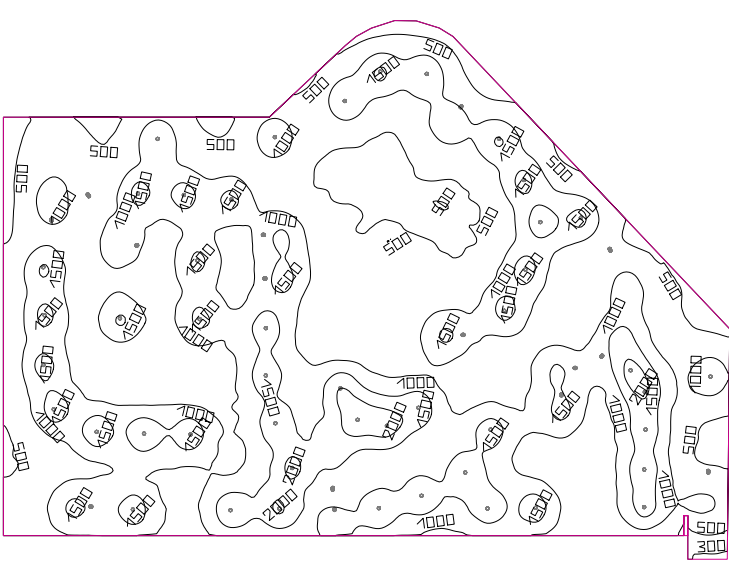

Reflection factors: Ceiling 75.5%, Walls 31.7%, Floor 90.0%, Maintenance factor: 0.80

Workplane

| Surface       | Result   | Average (Target) | Min | Max  | Min/average | Min/max |
|---------------|--|------------------|-----|------|-------------|---------|
| 1 Workplane 3 | Perpendicular illuminance (adaptive) [lx]<br>Height: 0.750 m, Wall zone: 0.000 m | 1020 (≥ 500)     | 276 | 2404 | 0.27        | 0.11    |

| #                        | Luminaire                                      | Φ(Luminaire) [lm] | Power [W] | Luminous efficacy [lm/W] |
|--------------------------|--|-------------------|-----------|--------------------------|
| 62                       | AURORA - LED Eddi Reflector 2000lm Medium beam | 1942              | 19.0      | 102.2                    |
| Total via all luminaires |  | 120404            | 1178.0    | 102.2                    |

Lighting power density: 6.31 W/m² = 0.62 W/m²/100 lx (Floor area of room 186.66 m²)

The energy consumption quantities refer to the lights planned for the room without taking into account light scenes and their dimming levels.  
Consumption: 3250 kWh/a of maximum 6550 kWh/a

## Workplane 3 / Perpendicular illuminance (adaptive)

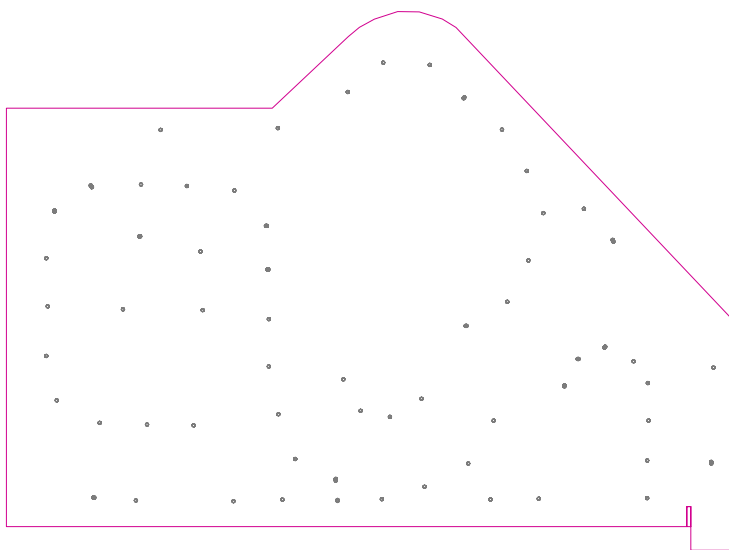

Workplane 3: Perpendicular illuminance (adaptive) (Surface)

Light scene: Light scene 1

Average: 1020 lx (Target:  $\geq 500$  lx), Min: 276 lx, Max: 2404 lx, Min/average: 0.27, Min/max: 0.11

Height: 0.750 m, Wall zone: 0.000 m

Isolines [lx]

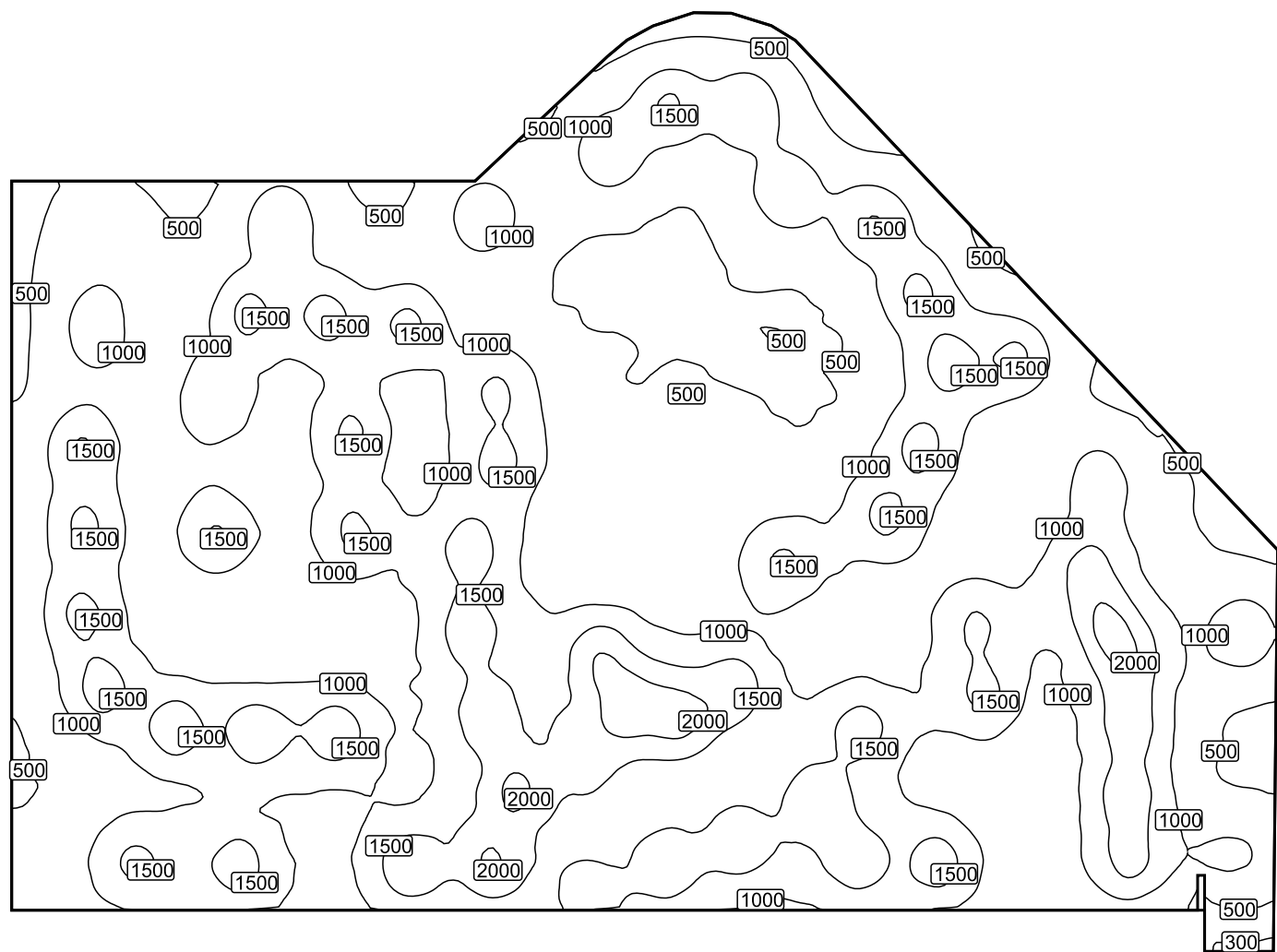

Scale: 1 : 100

## False colours [lx]

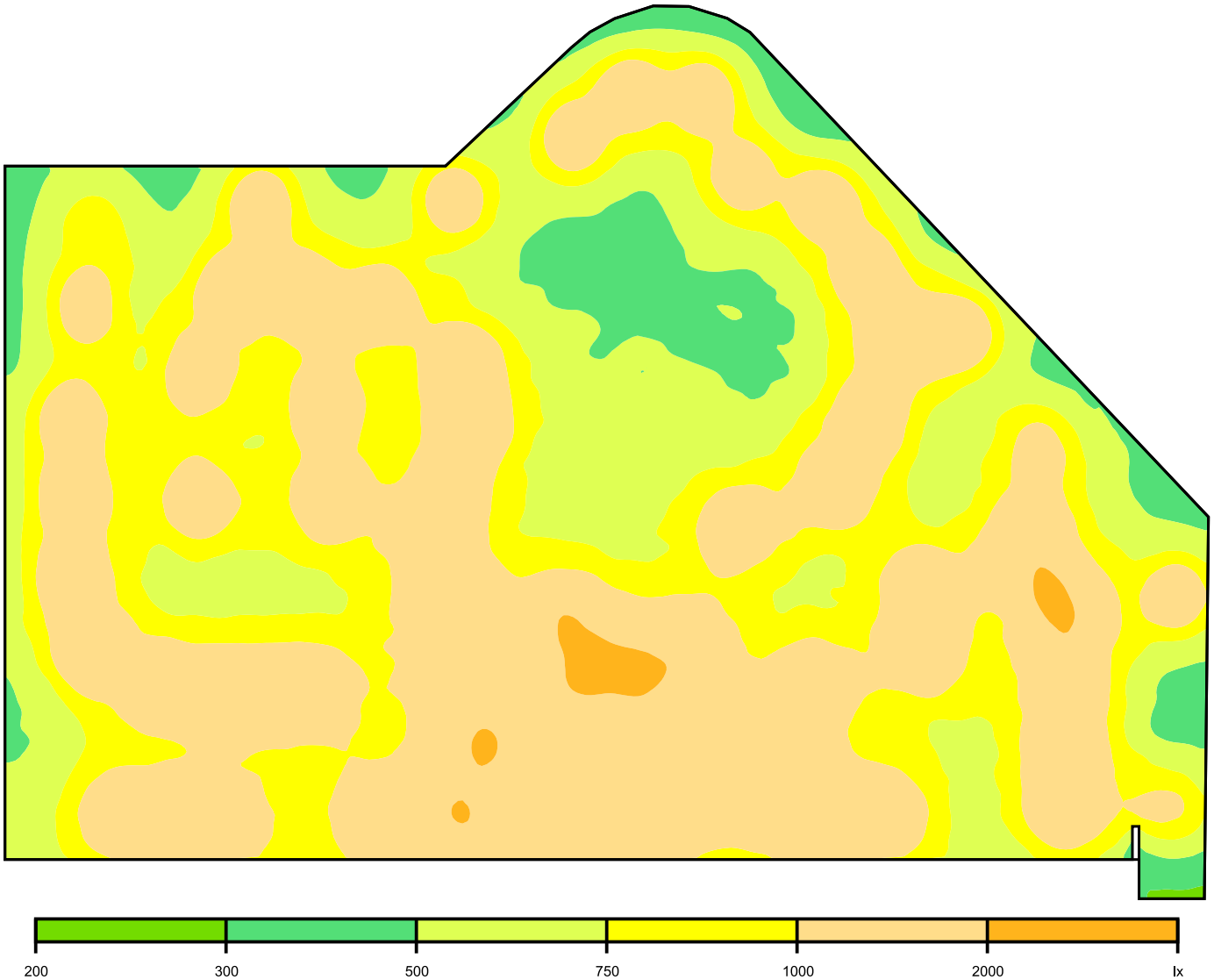

Scale: 1 : 100

## Value grid [lx]

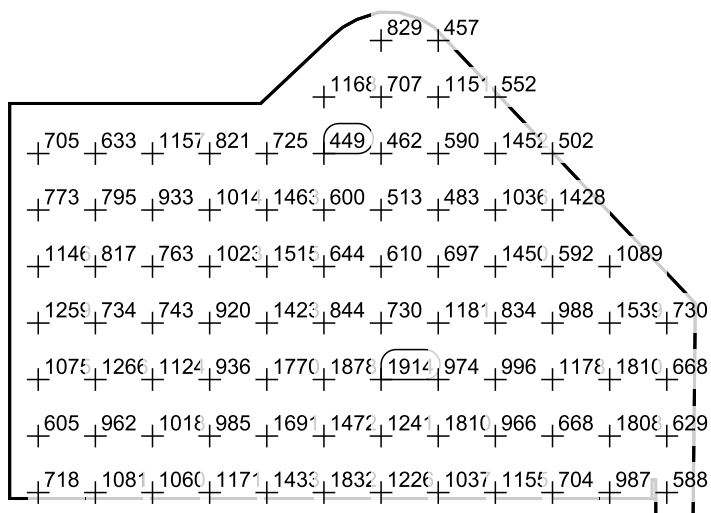

Scale: 1 : 200

Intro Gedeelte

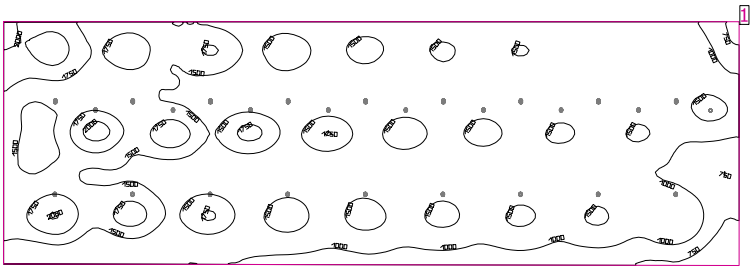

Reflection factors: Ceiling 75.5%, Walls 39.0%, Floor 90.0%, Maintenance factor: 0.80

Workplane

| Surface       | Result   | Average (Target) | Min | Max  | Min/average | Min/max |
|---------------|--|------------------|-----|------|-------------|---------|
| 1 Workplane 4 | Perpendicular illuminance (adaptive) [lx]<br>Height: 0.800 m, Wall zone: 0.000 m | 1359 (≥ 500)     | 533 | 2171 | 0.39        | 0.25    |

| #                        | Luminaire                                      | Φ(Luminaire) [lm] | Power [W] | Luminous efficacy [lm/W] |
|--------------------------|--|-------------------|-----------|--------------------------|
| 27                       | AURORA - LED Eddi Reflector 3000lm Medium beam | 2958              | 31.0      | 95.4                     |
| Total via all luminaires |  | 79866             | 837.0     | 95.4                     |

Lighting power density: 8.11 W/m² = 0.60 W/m²/100 lx (Floor area of room 103.21 m²)

The energy consumption quantities refer to the lights planned for the room without taking into account light scenes and their dimming levels.  
Consumption: 2300 kWh/a of maximum 3650 kWh/a



## Workplane 4 / Perpendicular illuminance (adaptive)

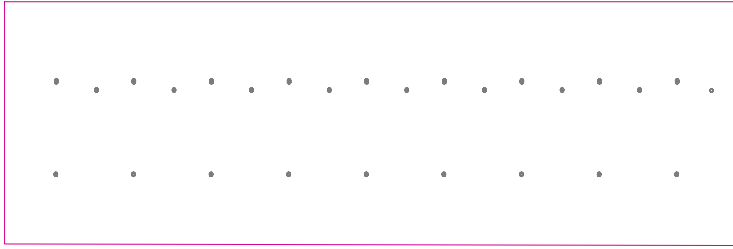

## Workplane 4: Perpendicular illuminance (adaptive) (Surface)

Light scene: Light scene 1

Average: 1359 lx (Target:  $\geq 500$  lx), Min: 533 lx, Max: 2171 lx, Min/average: 0.39, Min/max: 0.25

Height: 0.800 m, Wall zone: 0.000 m

## Isolines [lx]

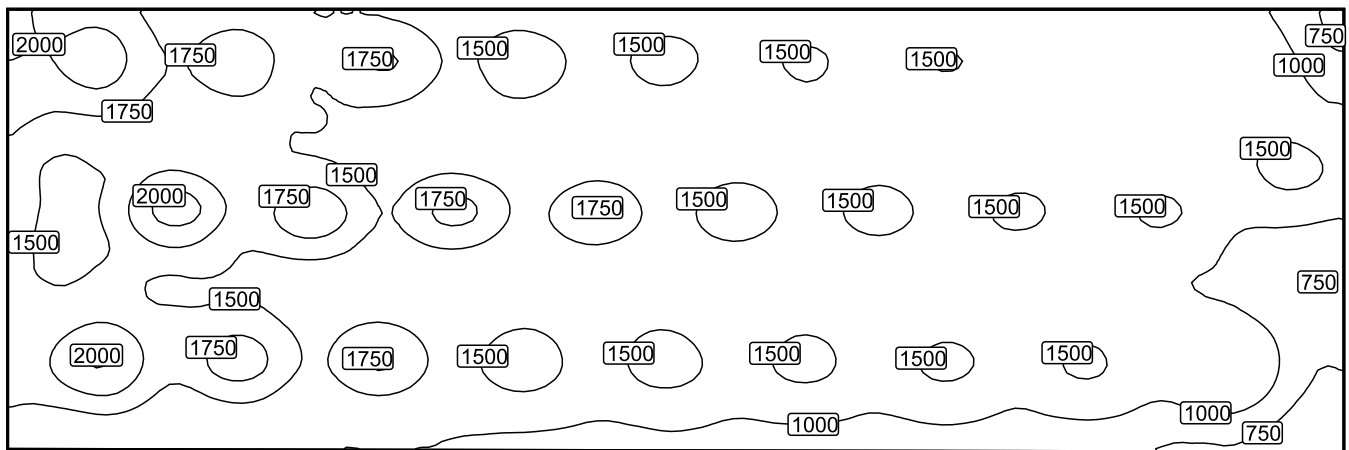

Scale: 1 : 100

## False colours [lx]

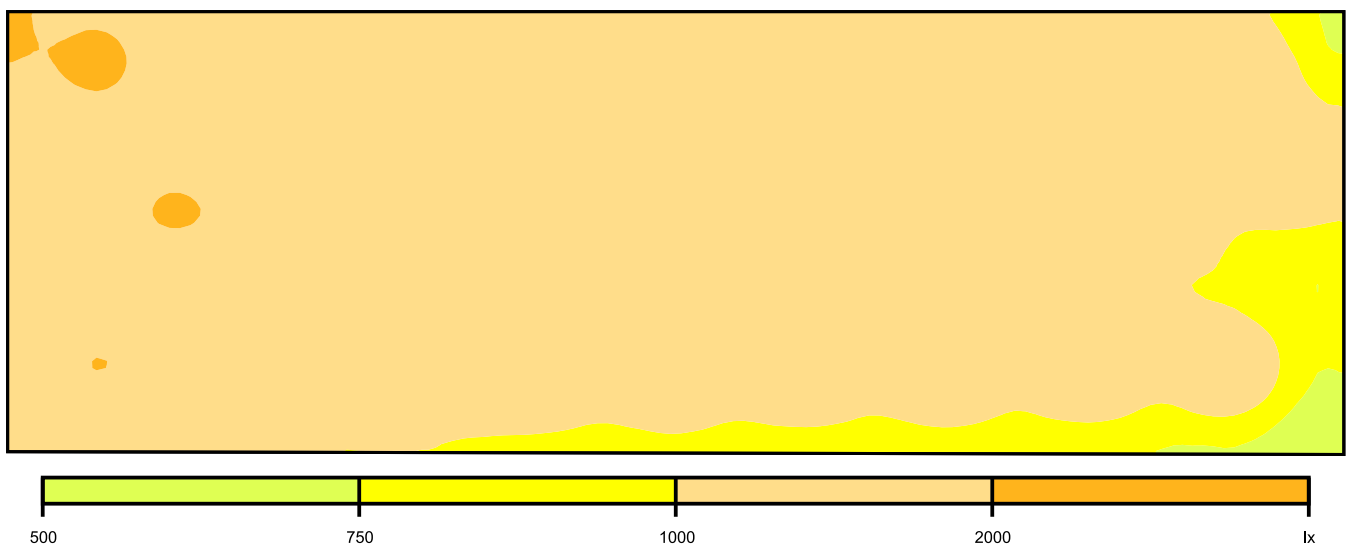

Scale: 1 : 100

## Value grid [lx]

|     |     |     |     |     |     |     |     |     |     |     |     |     |     |     |     |     |     |     |     |     |     |     |     |     |      |      |
|-----|-----|-----|-----|-----|-----|-----|-----|-----|-----|-----|-----|-----|-----|-----|-----|-----|-----|-----|-----|-----|-----|-----|-----|-----|------|------|
| 203 | 203 | 189 | 168 | 177 | 166 | 156 | 163 | 151 | 144 | 151 | 136 | 139 | 148 | 130 | 137 | 141 | 125 | 137 | 138 | 122 | 137 | 128 | 118 | 129 | 110  | 762  |
| 186 | 200 | 187 | 169 | 182 | 165 | 152 | 166 | 151 | 145 | 161 | 137 | 140 | 149 | 131 | 137 | 146 | 127 | 140 | 138 | 122 | 135 | 127 | 117 | 137 | 124  | 949  |
| 169 | 163 | 166 | 162 | 156 | 151 | 148 | 142 | 138 | 136 | 134 | 132 | 129 | 130 | 127 | 125 | 123 | 122 | 119 | 118 | 119 | 113 | 111 | 115 | 123 | 137  | 1262 |
| 153 | 143 | 165 | 188 | 163 | 160 | 164 | 143 | 153 | 152 | 138 | 148 | 144 | 131 | 148 | 137 | 126 | 141 | 130 | 122 | 137 | 121 | 123 | 135 | 122 | 151  | 1452 |
| 151 | 142 | 168 | 193 | 163 | 172 | 177 | 146 | 162 | 163 | 138 | 162 | 155 | 134 | 160 | 145 | 128 | 154 | 133 | 129 | 149 | 122 | 131 | 145 | 109 | 977  | 924  |
| 152 | 150 | 152 | 149 | 148 | 142 | 138 | 137 | 131 | 126 | 129 | 123 | 122 | 123 | 118 | 119 | 116 | 114 | 116 | 112 | 109 | 109 | 106 | 103 | 977 | 856  | 754  |
| 166 | 176 | 170 | 157 | 166 | 154 | 144 | 154 | 139 | 135 | 151 | 129 | 136 | 146 | 123 | 132 | 138 | 121 | 133 | 131 | 119 | 132 | 122 | 112 | 125 | 1964 | 802  |
| 163 | 189 | 179 | 156 | 178 | 159 | 147 | 171 | 147 | 143 | 163 | 132 | 141 | 159 | 128 | 143 | 151 | 119 | 148 | 146 | 117 | 148 | 132 | 114 | 139 | 107  | 735  |
| 134 | 133 | 132 | 120 | 122 | 117 | 110 | 112 | 108 | 104 | 104 | 996 | 973 | 102 | 957 | 985 | 969 | 915 | 965 | 985 | 895 | 914 | 890 | 828 | 866 | 760  | 576  |

Scale: 1 : 100

# Introfashion - Bobo

Datasheets

## ACCENT - EDDI

268-6521

### Product Description

Eddi™ Downlight Tilt Adjustable Accent luminaire, for recessing into ceiling in White complete with 1 x 19W 2000lm 3000K 80 CRI LED COB(s) with Medium Beam Reflector

### Product Image:



### Line Drawing Image

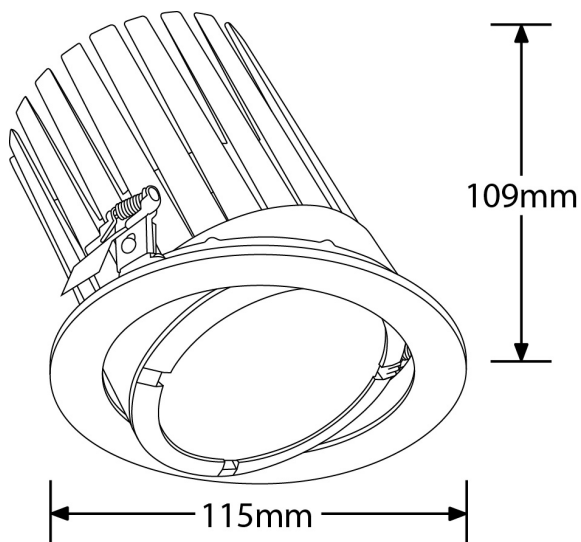

### Photometrics

| Medium Beam 34° 19W 2000lm 3000K |                   |              |
|----------------------------------|-------------------|--------------|
| Peak (Lux)                       | Cone Diameter (m) | Distance (m) |
| 4996                             | 0.6               | 1            |
| 1249                             | 1.2               | 2            |
| 555                              | 1.8               | 3            |

### Product Specification

|                           |             |                       |                            |
|---------------------------|-------------|-----------------------|----------------------------|
| Technology                | LED         | Input Voltage         | 220-240V                   |
| Power Factor              | 0.9         | IP Rating             | IP20                       |
| SDCM                      | 3           | CRI                   | 80                         |
| Dimming                   | No          | Mount Type            | for recessing into ceiling |
| Max Height                | 109mm       | Length                | 115mm                      |
| Overall Diameter          | 115mm       | Weight                | 0.75                       |
| Lumens Per W              | 95.24LL/TCW | Lifetime              | 50000 hours L80,B10        |
| Light Source Manufacturer | Philips     | Horizontal Adjustment | 20°                        |
| Distribution Type         | Accent      | Warranty              | 5 Years                    |
| Cut Out Diameter          | 100mm       |                       |                            |

### SKU Table and Ordering

| SKU Code | Lumens | Beam Angle | Finish Colour | Colour Temperature | Wattage |
|----------|--------|------------|---------------|--------------------|---------|
| 268-6521 | 1x2000 | 34         | White         | 3000               | 1x19    |

## ACCENT - EDDI

268-6541

### Product Description

Eddi™ Downlight Tilt Adjustable Accent luminaire, for recessing into ceiling in White complete with 1 x 31W 3000lm 3500K 80 CRI LED COB(s) with Medium Beam Reflector

### Product Image:



### Line Drawing Image

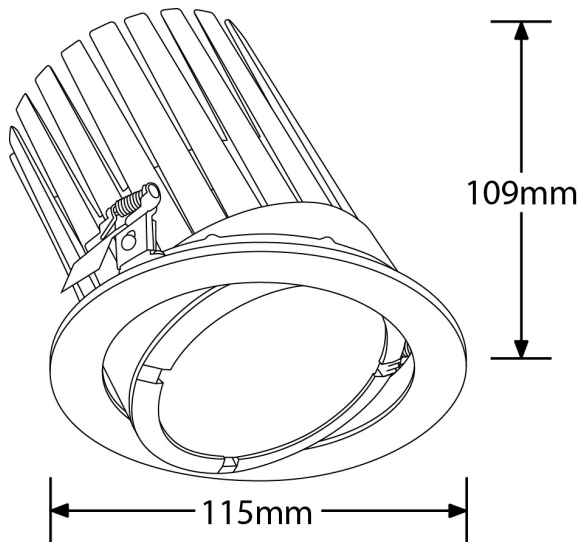

### Photometrics

| Medium Beam 34° 31W 3000lm 3000K |                   |              |
|----------------------------------|-------------------|--------------|
| Peak (Lux)                       | Cone Diameter (m) | Distance (m) |
| 6776                             | 0.6               | 1            |
| 1694                             | 1.3               | 2            |
| 753                              | 1.9               | 3            |

Image is representative for range. For further information contact your local office.

### Product Specification

|                           |             |                       |                            |
|---------------------------|-------------|-----------------------|----------------------------|
| Technology                | LED         | Input Voltage         | 220-240V                   |
| Power Factor              | 0.9         | IP Rating             | IP20                       |
| SDCM                      | 3           | CRI                   | 80                         |
| Dimming                   | No          | Mount Type            | for recessing into ceiling |
| Max Height                | 109mm       | Length                | 115mm                      |
| Overall Diameter          | 115mm       | Weight                | 0.75                       |
| Lumens Per W              | 84.51LL/TCW | Lifetime              | 50000 hours L70,B50        |
| Light Source Manufacturer | Philips     | Horizontal Adjustment | 20°                        |
| Distribution Type         | Accent      | Warranty              | 5 Years                    |
| Cut Out Diameter          | 100mm       |                       |                            |

### SKU Table and Ordering

| SKU Code | Lumens | Beam Angle | Finish Colour | Colour Temperature | Wattage |
|----------|--------|------------|---------------|--------------------|---------|
| 268-6541 | 1x3000 | 34         | White         | 3500               | 1x31    |

## ACCENT - EDDI

268-6526

### Product Description

Eddi™ Downlight Tilt Adjustable Accent luminaire, for recessing into ceiling in White complete with 1 x 19W 2000lm 3500K 80 CRI LED COB(s) with Wide Beam Reflector

### Product Image:



### Line Drawing Image

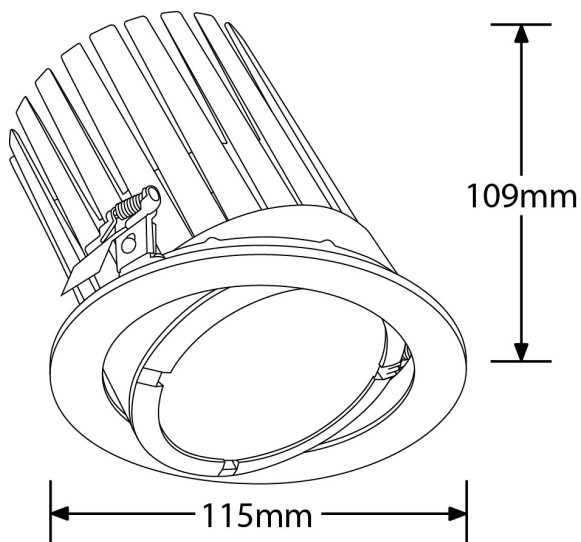

### Photometrics

| Wide Beam 53° 19W 2000lm 3000K |                   |              |
|--------------------------------|-------------------|--------------|
| Peak (Lux)                     | Cone Diameter (m) | Distance (m) |
| 2702                           | 1.1               | 1            |
| 675                            | 2.1               | 2            |
| 300                            | 3.2               | 3            |

Image is representative for range. For further information contact your local office.

### Product Specification

|                           |              |                       |                            |
|---------------------------|--------------|-----------------------|----------------------------|
| Technology                | LED          | Input Voltage         | 220-240V                   |
| Power Factor              | 0.9          | IP Rating             | IP20                       |
| SDCM                      | 3            | CRI                   | 80                         |
| Dimming                   | No           | Mount Type            | for recessing into ceiling |
| Max Height                | 109mm        | Length                | 115mm                      |
| Overall Diameter          | 115mm        | Weight                | 0.75                       |
| Lumens Per W              | 102.84LL/TCW | Lifetime              | 50000 hours L80,B10        |
| Light Source Manufacturer | Philips      | Horizontal Adjustment | 20°                        |
| Distribution Type         | Accent       | Warranty              | 5 Years                    |
| Cut Out Diameter          | 100mm        |                       |                            |

### SKU Table and Ordering

| SKU Code | Lumens | Beam Angle | Finish Colour | Colour Temperature | Wattage |
|----------|--------|------------|---------------|--------------------|---------|
| 268-6526 | 1x2000 | 53         | White         | 3500               | 1x19    |

## ACCENT - EDDI

268-6525

### Product Description

Eddi™ Downlight Tilt Adjustable Accent luminaire, for recessing into ceiling in White complete with 1 x 19W 2000lm 3500K 80 CRI LED COB(s) with Medium Beam Reflector

### Product Image:



### Line Drawing Image

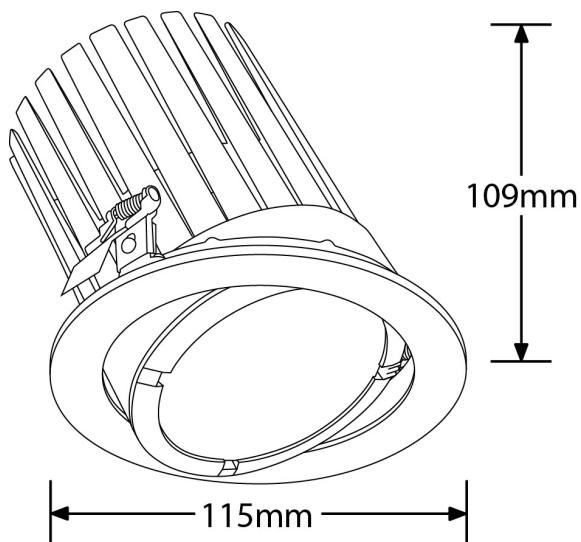

### Photometrics

| Medium Beam 34° 19W 2000lm 3000K |                   |              |
|----------------------------------|-------------------|--------------|
| Peak (Lux)                       | Cone Diameter (m) | Distance (m) |
| 4996                             | 0.6               | 1            |
| 1249                             | 1.2               | 2            |
| 555                              | 1.8               | 3            |

Image is representative for range. For further information contact your local office.

### Product Specification

|                           |           |                       |                            |
|---------------------------|-----------|-----------------------|----------------------------|
| Technology                | LED       | Input Voltage         | 220-240V                   |
| Power Factor              | 0.9       | IP Rating             | IP20                       |
| SDCM                      | 3         | CRI                   | 80                         |
| Dimming                   | No        | Mount Type            | for recessing into ceiling |
| Max Height                | 109mm     | Length                | 115mm                      |
| Overall Diameter          | 115mm     | Weight                | 0.75                       |
| Lumens Per W              | 102LL/TCW | Lifetime              | 50000 hours L80,B10        |
| Light Source Manufacturer | Philips   | Horizontal Adjustment | 20°                        |
| Distribution Type         | Accent    | Warranty              | 5 Years                    |
| Cut Out Diameter          | 100mm     |                       |                            |

### SKU Table and Ordering

| SKU Code | Lumens | Beam Angle | Finish Colour | Colour Temperature | Wattage |
|----------|--------|------------|---------------|--------------------|---------|
| 268-6525 | 1x2000 | 34         | White         | 3500               | 1x19    |

## ACCENT - EDDI

268-6509

### Product Description

Eddi™ Downlight Tilt Adjustable Accent luminaire, for recessing into ceiling in White complete with 1 x 10W 1000lm 3500K 80 CRI LED COB(s) with Medium Beam Reflector

### Product Image:



### Line Drawing Image

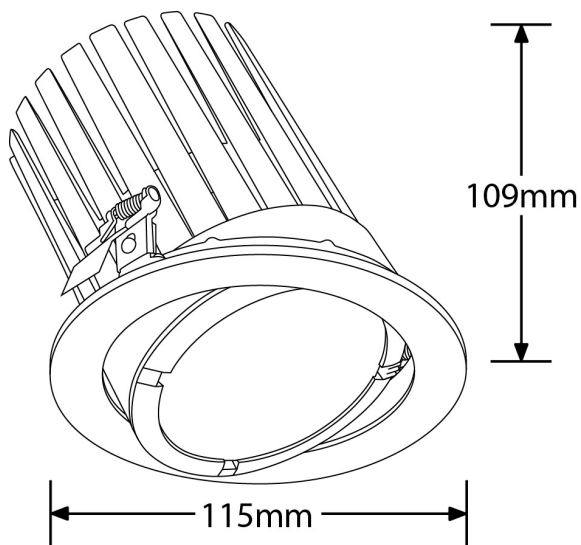

### Photometrics

| Medium Beam 34° 10W 1000lm 3000K |                   |              |
|----------------------------------|-------------------|--------------|
| Peak (Lux)                       | Cone Diameter (m) | Distance (m) |
| 2208                             | 0.6               | 1            |
| 552                              | 1.3               | 2            |
| 245                              | 1.9               | 3            |

Image is representative for range. For further information contact your local office.

### Product Specification

|                           |            |                       |                            |
|---------------------------|------------|-----------------------|----------------------------|
| Technology                | LED        | Input Voltage         | 220-240V                   |
| Power Factor              | 0.9        | IP Rating             | IP20                       |
| SDCM                      | 3          | CRI                   | 80                         |
| Dimming                   | No         | Mount Type            | for recessing into ceiling |
| Max Height                | 109mm      | Length                | 115mm                      |
| Overall Diameter          | 115mm      | Weight                | 0.75                       |
| Lumens Per W              | 96.4LL/TCW | Lifetime              | 50000 hours L80,B10        |
| Light Source Manufacturer | Philips    | Horizontal Adjustment | 20°                        |
| Distribution Type         | Accent     | Warranty              | 5 Years                    |
| Cut Out Diameter          | 100mm      |                       |                            |

### SKU Table and Ordering

| SKU Code | Lumens | Beam Angle | Finish Colour | Colour Temperature | Wattage |
|----------|--------|------------|---------------|--------------------|---------|
| 268-6509 | 1x1000 | 34         | White         | 3500               | 1x10    |



# ACCENT - EDDI

121-3029

## Product Description

Eddi™ T1 Adjustable Accent luminaire, fitted with 3 circuit track adaptor in White complete with 1 x 31W 3000lm 3500K 80 CRI LED COB(s) with Medium Beam Reflector

## Product Image:



## Line Drawing Image

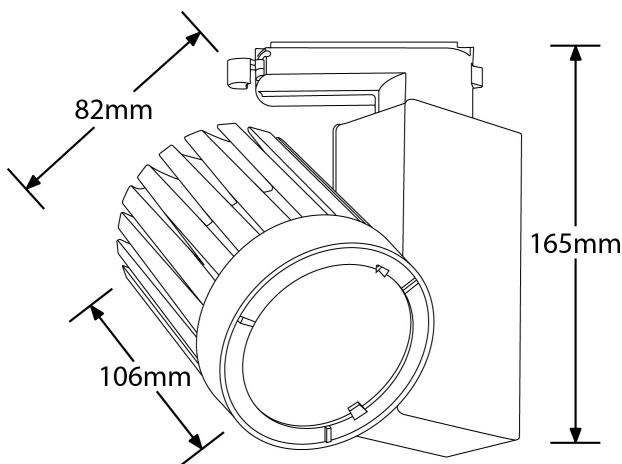

## Photometrics

| Medium Beam 34° 31W 3000lm 3000K |                   |              |
|----------------------------------|-------------------|--------------|
| Peak (Lux)                       | Cone Diameter (m) | Distance (m) |
| 6776                             | 0.6               | 1            |
| 1694                             | 1.3               | 2            |
| 753                              | 1.9               | 3            |

Image is representative for range. For further information contact your local office.

## Product Specification

|                   |                     |                           |                                     |
|-------------------|---------------------|---------------------------|-------------------------------------|
| Technology        | LED                 | Input Voltage             | 220-240V                            |
| Power Factor      | 0.9                 | IP Rating                 | IP20                                |
| SDCM              | 3                   | CRI                       | 80                                  |
| Dimming           | No                  | Mount Type                | fitted with 3 circuit track adaptor |
| Max Height        | 165mm               | Length                    | 106mm                               |
| Width             | 82mm                | Overall Diameter          | 82mm                                |
| Weight            | 1.1                 | Lumens Per W              | 84.51LL/TCW                         |
| Lifetime          | 50000 hours L70,B50 | Light Source Manufacturer | Philips                             |
| Rotation          | 310°                | Horizontal Adjustment     | 180°                                |
| Distribution Type | Accent              | Warranty                  | 5 Years                             |

## SKU Table and Ordering

| SKU Code | Lumens | Beam Angle | Finish Colour | Colour Temperature | Wattage |
|----------|--------|------------|---------------|--------------------|---------|
| 121-3029 | 1x3000 | 34         | White         | 3500               | 1x31    |

## Compliance & Approvals :



# ACCENT - EDDI

121-3017

## Product Description

Eddi™ T1 Adjustable Accent luminaire, fitted with 3 circuit track adaptor in White complete with 1 x 19W 2000lm 3500K 80 CRI LED COB(s) with Medium Beam Reflector

## Product Image:



## Line Drawing Image

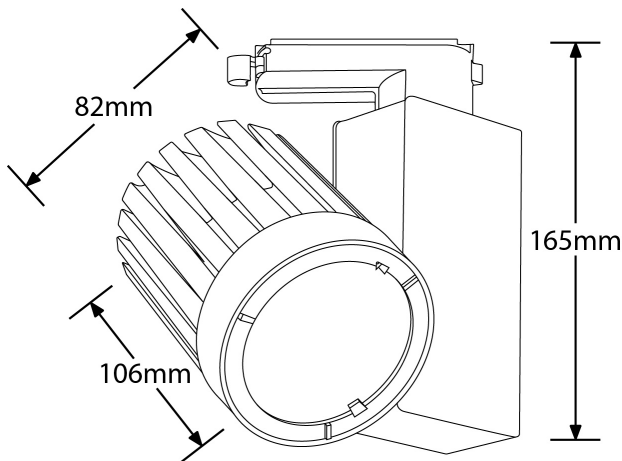

## Photometrics

| Medium Beam 34° 19W 2000lm 3000K |                   |              |
|----------------------------------|-------------------|--------------|
| Peak (Lux)                       | Cone Diameter (m) | Distance (m) |
| 4996                             | 0.6               | 1            |
| 1249                             | 1.2               | 2            |
| 555                              | 1.8               | 3            |

Image is representative for range. For further information contact your local office.

## Product Specification

|                   |                     |                           |                                     |
|-------------------|---------------------|---------------------------|-------------------------------------|
| Technology        | LED                 | Input Voltage             | 220-240V                            |
| Power Factor      | 0.9                 | IP Rating                 | IP20                                |
| SDCM              | 3                   | CRI                       | 80                                  |
| Dimming           | No                  | Mount Type                | fitted with 3 circuit track adaptor |
| Max Height        | 165mm               | Length                    | 106mm                               |
| Width             | 82mm                | Overall Diameter          | 82mm                                |
| Weight            | 1.1                 | Lumens Per W              | 102LL/TCW                           |
| Lifetime          | 50000 hours L80,B10 | Light Source Manufacturer | Philips                             |
| Rotation          | 310°                | Horizontal Adjustment     | 180°                                |
| Distribution Type | Accent              | Warranty                  | 5 Years                             |

## SKU Table and Ordering

| SKU Code | Lumens | Beam Angle | Finish Colour | Colour Temperature | Wattage |
|----------|--------|------------|---------------|--------------------|---------|
| 121-3017 | 1x2000 | 34         | White         | 3500               | 1x19    |

## Compliance & Approvals :



### Product Description:

LEDline™ PRO single colour 24V super bright LED strip is ideal for when LED strip with a higher lumen output is required. Increased brightness by using twice as many LEDs per metre than standard LED strip. Low power consumption of 9.6W per metre. Strip can be cut to length and 2m leads soldered to special order.

### Product Image:

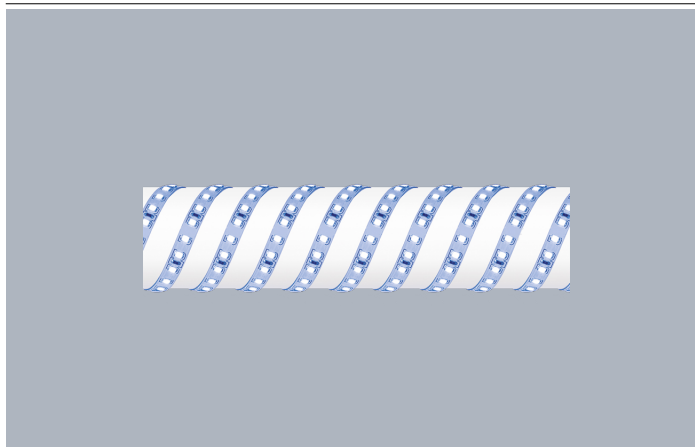

### Product Features:

- High density single colour flexible LED strip with 3M™ self adhesive backing
- Beam angle of 120° and 9mm between LEDs, 120 LEDs per metre
- Cut points every 50mm for maximum flexibility
- Voltage drop of 4.5V per 10m and maximum run of 10m
- For runs over 10m individual lengths should be connected in parallel
- Requires 24V LED driver (sold separately)
- Reel length of 10m
- 3 year warranty

Flexible 24V DC Single Colour LED Strip Light

### Product Specs:

|                    |       |                          |           |
|--------------------|-------|--------------------------|-----------|
| Technology         | LED   | Number of LEDs           | 120       |
| Lifetime L70 (hrs) | 35000 | Input Voltage            | 24~24V DC |
| Dimmable           | Yes   | IP Rating                | IP20      |
| Fire Protection    | No    | Operating Temp. (Max) °C | 40        |
| Lamp Base          | None  | Height (mm)              | 2         |
| Length (mm)        | 10000 | Width (mm)               | 8         |
| SDCM               | 6     |                          |           |

### SKU Table and Ordering

| SKU Code     | Wattage | Lumens | Lumens/Watt | Colour | Beam Angle | Ra | SDCM |
|--------------|---------|--------|-------------|--------|------------|----|------|
| EN-ST224/27  | 9.6     | 960    | 100         | 2700   | 120        | 80 | 6    |
| EN-ST224/30  | 9.6     | 960    | 100         | 3000   | 120        | 80 | 6    |
| EN-ST224/40  | 9.6     | 1027   | 106.98      | 4000   | 120        | 80 | 6    |
| EN-ST224/60  | 9.6     | 1084   | 112.92      | 6300   | 120        | 80 | 6    |
| EN-ST224/BLU | 9.6     |        |             |        | 120        | 80 | 6    |

### Compliance & Approvals:





## Warranty

---

This product has a warranty period of 3 Years.

Warranties are valid from the date of purchase. The warranty is invalid in the case of improper use, installation, tampering, removal of the Q.C. date label or installation in an improper working environment or installation. Should this product fail during the warranty period it will be replaced free of charge, subject to the correct installation of the original product and subsequent return of the faulty unit. Aurora does not accept responsibility for any installation costs associated with the replacement of this product and Aurora reserves the right to alter specifications without prior notice.

### **UK Enlite Sales & Distribution**

Apex Park

6 Little Burrow

Welwyn Garden City AL7 4SW

United Kingdom

Tel : +44 (0) 1707 35 18 20

### Product Features:

- Registered Community Design 001886730
- For the supply of low voltage LED lamps
- 24V DC output
- Overload protection
- Short circuit protection
- Thermal protection, 50mm clearance needed for heat dissipation
- Secondary wiring terminals - 3 outputs
- Loop-in, loop-out primary wiring terminals
- Integrated earth terminal for earth continuity
- No junction box required
- 1.0kV SURGE PROTECTION – EN 61547
- Safety compliance – EN 61347
- EMC compliance – EN 55015, EN 61000, EN 61547
- Non-dimmable
- Parallel wiring only
- 3 Year Warranty - see [www.auroralighting.com](http://www.auroralighting.com) for details

### Product Image:



50W Non-Dimmable 24V Constant Voltage Driver

### Product Specs:

|                       |               |                   |       |
|-----------------------|---------------|-------------------|-------|
| Input Voltage         | 176~264V AC   | Dimmable          | No    |
| Lamp Base             | None          | Width (mm)        | 48    |
| Length (mm)           | 188           | Weight (Kg)       | 0.243 |
| Positional Adjustment | Fixed         | Case Cover Colour | Red   |
| Case Material         | Polycarbonate |                   |       |

### SKU Table and Ordering:

| SKU Code     | Wattage |
|--------------|---------|
| AU-LED5024CV | 50      |

### Compliance & Approvals:

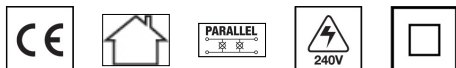

### Warranty:

This product has a warranty period of 1 Year. Warranties may be available on certain products as indicated in the product description. Warranties are valid from the date of purchase. The warranty is invalid in the case of improper use, installation, tampering, removal of the Q.C. date label or installation in an improper working environment or installation. Should this product fail during the warranty period it will be replaced free of charge, subject to the correct installation of the original product and subsequent return of the faulty unit. Aurora does not accept responsibility for any installation costs associated with the replacement of this product and Aurora reserves the right to alter specifications without prior notice.

## LUMINAIRES - LED FLAT PANEL

EN-FP1230C

### Product Description:

The E6060™ has been upgraded to produce 95lm/W for outstanding energy savings. The light guide board and diffuser have been engineered to ensure maximum light output and complete uniformity. Suitable for a wide range of applications including office, education and commercial spaces.

### Product Image:



### Product Features:

- Edge-lit design and optical pattern light guide engineered for even light distribution
- Suitable for installation in 15 & 24mm T-bar ceilings
- SDCM <5 providing consistent light colour quality
- UGR 19 (Unified Glare Rating) - suitable for use in offices
- Flicker free driver - Power Factor >0.9
- Life not affected by frequent switching e.g. when used with occupancy controls
- 1-10V dimmable, DALI and emergency versions available
- Surface mount box and adjustable suspension kit available
- 1.5kV surge protection
- 3 year warranty

36W 1200mm x 300mm LED Flat Panel

### Line Drawing Image

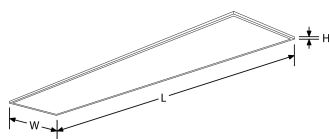

### Polar Curve Image

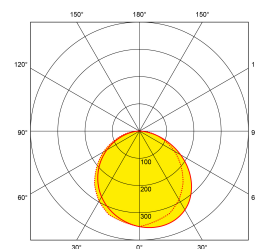

### Product Specs:

|                          |         |                |             |
|--------------------------|---------|----------------|-------------|
| Technology               | LED     | Number of LEDs | 140         |
| Lifetime L70 (hrs)       | 30000   | Input Voltage  | 220~240V AC |
| Input Frequency          | 50/60HZ | Dimmable       | No          |
| Dali                     | No      | IP Rating      | IP20        |
| Operating Temp. (Max) °C | 40      | Power Factor   | 0.9         |
| Lamp Base                | None    | Height (mm)    | 10          |
| Length (mm)              | 1195    | Width (mm)     | 295         |
| Surge Protection (kV)    | 1.5     | SDCM           | 5           |



## SKU Table and Ordering

| SKU Code        | Wattage | Lumens | Lumens/Watt | Colour | Beam Angle | Ra | SDCM |
|-----------------|---------|--------|-------------|--------|------------|----|------|
| EN-FP1230C/40   | 36      | 3400   | 94.44       | 4000   | 110        | 80 | 5    |
| EN-FP1230C/50   | 36      | 3400   | 94.44       | 5000   | 110        | 80 | 5    |
| EN-FP1230CDA/40 | 36      | 3400   | 94.44       | 4000   | 110        | 80 | 5    |
| EN-FP1230CDA/50 | 36      | 3400   | 94.44       | 5000   | 110        | 80 | 5    |
| EN-FP1230CV/40  | 36      | 3400   | 94.44       | 4000   | 110        | 80 | 5    |
| EN-FP1230CV/50  | 36      | 3400   | 94.44       | 5000   | 110        | 80 | 5    |

## Compliance & Approvals:



## Accessories:

| SKU Image  | SKU Code    | Description   |
|--|-------------|---|
|   | EN-LPEM2    | 3 Hour Non-Maintained Emergency Pack for Enlite Panel Range |
|   | EN-SK100B   | Panel Adjustable Suspension Kit                             |
|   | EN-SM107B   | 1200 x 300 x 74mm Panel Surface Mount                       |
|  | EN-CRM1230A | 1200 x 300mm Panel Recess Mount                             |

## Warranty

This product has a warranty period of 3 Years. Warranties are valid from the date of purchase. The warranty is invalid in the case of improper use, installation, tampering, removal of the Q.C. date label or installation in an improper working environment or installation. Should this product fail during the warranty period it will be replaced free of charge, subject to the correct installation of the original product and subsequent return of the faulty unit. Aurora does not accept responsibility for any installation costs associated with the replacement of this product and Aurora reserves the right to alter specifications without prior notice.

**UK Enlite Sales & Distribution**  
Apex Park  
6 Little Burrow  
Welwyn Garden City AL7 4SW  
United Kingdom  
Tel : +44 (0) 1707 35 18 20



## LUMINAIRES - DOWNLIGHTS

## EN-DL23

### Product Description:

Performance and Value - that's what the Uni-Fit™ range of commercial downlights stands for. Featuring ThermoTec™ technology, integrated driver and high quality LED chips to deliver an outstanding lumen performance. The triac dimmable Uni-Fit™ range is the ideal cost effective solution for new or existing installations where traditional compact fluorescent downlights need upgrading to more efficient LED technology.

### Product Image:



### Product Features:

- Multiple sizes and wattages available to suit all new and retrofit installation lighting requirements
- ThermoTec™ technology utilises a combination of highly efficient LED light source, aluminium heat sinking and thermoplastic material for longer life and consistent performance
- Compact integrated driver for easy installation and shallow ceiling voids
- Life not affected by frequent switching e.g. when used with occupancy controls
- IP44 rated
- Pre-wired with 500mm 2 core cable
- 1.5kV surge protection
- 3 year warranty

### 23W Integrated IP44 Non-Dimmable LED Downlight

### Line Drawing Image

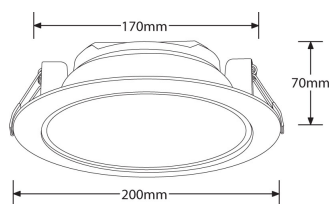

### Polar Curve Image

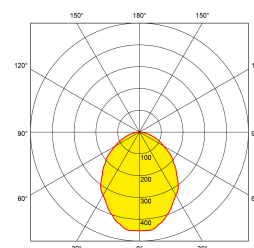

### Product Specs:

|                        |             |                          |         |
|------------------------|-------------|--------------------------|---------|
| Technology             | LED         | Number of LEDs           | 60      |
| Luminaire Distribution | Direct      | Lifetime L70 (hrs)       | 25000   |
| Input Voltage          | 220~240V AC | Input Frequency          | 50/60HZ |
| Dimmable               | No          | IP Rating                | IP44    |
| IK Rating              | IK06        | Operating Temp. (Max) °C | 40      |
| Power Factor           | 0.9         | Overall Diameter (mm)    | 200     |
| Recess Depth (mm)      | 70          | Cutout Diameter (mm)     | 170     |
| Lamp Base              | None        | Height (mm)              | 60      |
| Surge Protection (kV)  | 1.5         | SDCM                     | 6       |

SKU Table and Ordering

| SKU Code   | Wattage | Lumens | Lumens/Watt | Colour | Beam Angle | Ra | SDCM |
|------------|---------|--------|-------------|--------|------------|----|------|
| EN-DL23/30 | 23      | 2000   | 86.96       | 3000   | 100        | 80 | 6    |
| EN-DL23/40 | 23      | 2100   | 91.3        | 4000   | 100        | 80 |      |

Compliance & Approvals:



Accessories:

| SKU Image | SKU Code | Description                          |
|-----------|----------|--------------------------------------|
|           | EN-DLEM2 | 3 Hour Non-Maintained Emergency Pack |

Warranty

This product has a warranty period of 3 Years. Warranties are valid from the date of purchase. The warranty is invalid in the case of improper use, installation, tampering, removal of the Q.C. date label or installation in an improper working environment or installation. Should this product fail during the warranty period it will be replaced free of charge, subject to the correct installation of the original product and subsequent return of the faulty unit. Aurora does not accept responsibility for any installation costs associated with the replacement of this product and Aurora reserves the right to alter specifications without prior notice.

**UK Enlite Sales & Distribution**  
Apex Park  
6 Little Burrow  
Welwyn Garden City AL7 4SW  
United Kingdom  
Tel : +44 (0) 1707 35 18 20

**Product Description:**

The IP66 Orbital™ bulkhead range is simple yet perfect for bulkhead applications. Engineered with a tough polycarbonate body and opal diffuser for even light output with no LED hot spots, all versions and accessories are impact resistant and designed to last. Available in two wattages, white and black housing, interchangeable eyelid bezels, emergency and microwave options. This range ticks all the boxes for any installation. Life not affected by frequent switching e.g. when used with occupancy controls.

**Product Features:**

- IP66 LED bulkhead not affected by frequent switching
- IK10 polycarbonate body and diffuser for maximum vandal resistance
- Rear entry access wiring compartment allows for easy installation
- Interchangeable eyelid bezel accessory available
- Separate 20mm conduit side entry
- Wall or ceiling mounted - accessories included
- Emergency and microwave options available
- Adjustable light detector from 2-50 lux
- Adjustable hold time 5 seconds to 30 minutes
- 1.5kV surge protection
- 3 year warranty

**Product Image:**

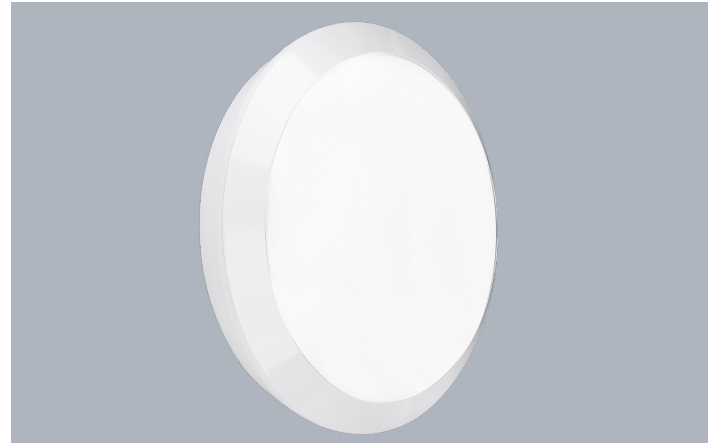

15W Polycarbonate IP66 Round LED Bulkhead

**Line Drawing Image**

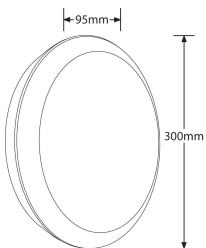

**Polar Curve Image**

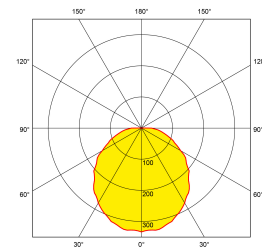

**Product Specs:**

|                        |             |                          |         |
|------------------------|-------------|--------------------------|---------|
| Technology             | LED         | Number of LEDs           | 88      |
| Luminaire Distribution | Direct      | Lifetime L70 (hrs)       | 25000   |
| Input Voltage          | 220~240V AC | Input Frequency          | 50/60HZ |
| Dimmable               | No          | IP Rating                | IP66    |
| IK Rating              | IK10        | Operating Temp. (Max) °C | 40      |
| Optic Material         | PC          | Power Factor             | 0.9     |
| Overall Diameter (mm)  | 300         | Lamp Base                | None    |
| Surge Protection (kV)  | 1.5         | SDCM                     | 6       |

SKU Table and Ordering

| SKU Code        | Wattage | Lumens | Lumens/Watt | Colour | Beam Angle | Ra | SDCM |
|-----------------|---------|--------|-------------|--------|------------|----|------|
| EN-BH15BLK/40   | 15      | 1150   | 76.67       | 4000   | 120        | 80 | 6    |
| EN-BH15BLK/40EM | 17      | 1150   | 67.65       | 4000   | 120        | 80 | 6    |
| EN-BH15BLK/40MS | 15      | 1150   | 76.67       | 4000   | 120        | 80 | 6    |
| EN-BH15W/40     | 15      | 1150   | 76.67       | 4000   | 120        | 80 | 6    |
| EN-BH15W/40EM   | 17      | 1150   | 67.65       | 4000   | 120        | 80 | 6    |
| EN-BH15W/40MS   | 15      | 1150   | 76.67       | 4000   | 120        | 80 | 6    |

Compliance & Approvals:



Accessories:

| SKU Image   | SKU Code | Description                           |
|---|----------|---------------------------------------|
|  | EN-BZE15 | Orbital™ 300mm Eyelid Bezel Accessory |

Warranty

This product has a warranty period of 3 Years.  
Warranties are valid from the date of purchase. The warranty is invalid in the case of improper use, installation, tampering, removal of the Q.C. date label or installation in an improper working environment or installation. Should this product fail during the warranty period it will be replaced free of charge, subject to the correct installation of the original product and subsequent return of the faulty unit. Aurora does not accept responsibility for any installation costs associated with the replacement of this product and Aurora reserves the right to alter specifications without prior notice.

UK Enlite Sales & Distribution  
Apex Park  
6 Little Burrow  
Welwyn Garden City AL7 4SW  
United Kingdom  
Tel : +44 (0) 1707 35 18 20

## LUMINAIRES - EMERGENCY LIGHTING

EN-EMLD2

### Product Description:

230-240V 2W 3 hour non-maintained LED Emergency. Includes LED driver and NiMH battery in a mesh sleeve. Compact downlight fits into a 44mm cut-out. LED module may also be mounted without downlight in a 20mm hole.

1 year guarantee.

### Product Image:



### Product Features:

2W 3 Hour Non-Maintained Emergency

### Product Specs:

|                       |          |                   |    |
|-----------------------|----------|-------------------|----|
| Technology            | LED      | Number of LEDs    | 1  |
| Input Voltage         | 220~240V | Dimmable          | No |
| IP Rating             | IP20     | Fire Protection   | No |
| Overall Diameter (mm) | 51       | Recess Depth (mm) | 70 |
| Cutout Diameter (mm)  | 40       | Height (mm)       | 47 |

### SKU Table and Ordering

| SKU Code | Wattage | Lumens | Lumens/Watt | Colour | Beam Angle |
|----------|---------|--------|-------------|--------|------------|
| EN-EMLD2 | 2       | 110    | 55          | 6400   | 40         |

### Compliance & Approvals:



## Warranty

---

This product has a warranty period of 1 Year.

Warranties are valid from the date of purchase. The warranty is invalid in the case of improper use, installation, tampering, removal of the Q.C. date label or installation in an improper working environment or installation. Should this product fail during the warranty period it will be replaced free of charge, subject to the correct installation of the original product and subsequent return of the faulty unit. Aurora does not accept responsibility for any installation costs associated with the replacement of this product and Aurora reserves the right to alter specifications without prior notice.

**UK Enlite Sales & Distribution**

Apex Park

6 Little Burrow

Welwyn Garden City AL7 4SW

United Kingdom

Tel : +44 (0) 1707 35 18 20

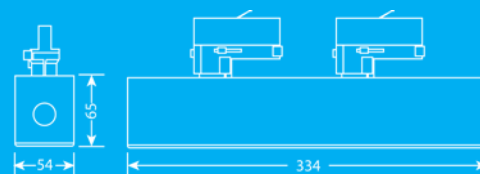

## Emergency Spot

### Details

#### Product

Emergency Non Maintained Track Spot

#### Part Number

777-3455-W

#### Description

Emergency non maintained with multi circuit track adaptor in white, complete with 2W battery pack (4x1.8 NiMH), extra wide beam.

#### Finish

White

### Technical

#### Dimensions

|         |       |
|---------|-------|
| Length: | 334mm |
| Width   | 54mm  |
| Height: | 65mm  |

#### Light Output

|                              |         |
|------------------------------|---------|
| Ingress Protection           | IP20    |
| No. of Lamps                 | 1       |
| Lamp Colour                  | 6200°K  |
| Circuit Wattage (inc losses) | 2W      |
| Warranty                     | 5 years |

### Standards

This unit complies with all Essential Requirements of the applicable Directives

Class I. Luminaires constructed and tested to comply with EN60598 1 & 2. All control gear and associated components comply with appropriate BS/VDE. Complies with ECA requirements.

**AURORA**

VALUE BEYOND ILLUMINATION